

Sketch Details	Sheet No	Quote #
Customer:	Site Address:	

LED handrail installation options

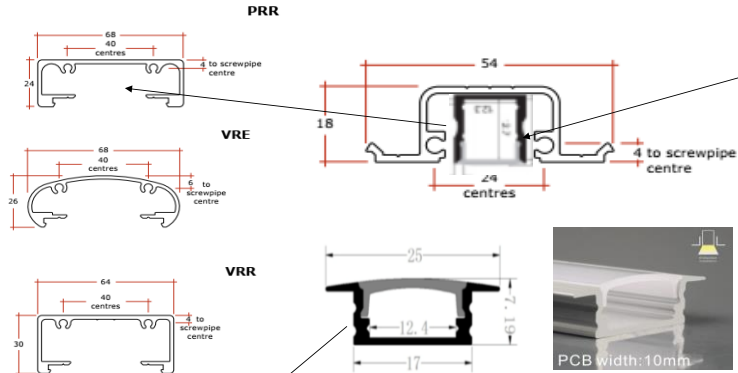

LED Aluminium Extrusion Recessed Profile for LED strip ALU-1706B

LRS 44.5mm diameter, circular rail with glazing recess.

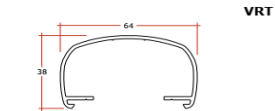

VRT

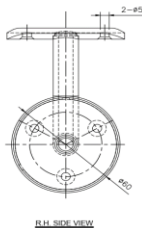
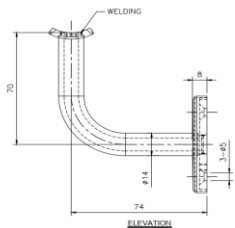
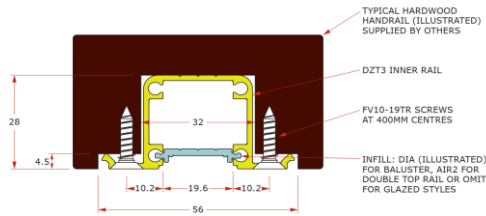

Handrail Brackets with a hollow stem for running electrical cable
Enables connection to power for LED light strip (not included)

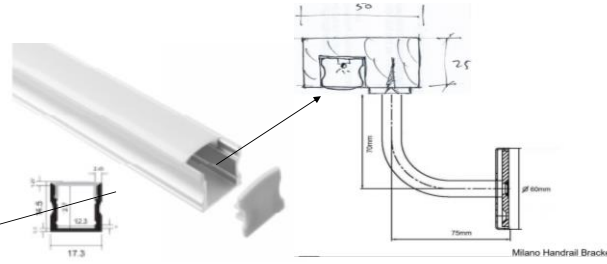

ICL Oneup Aluminium Profile 17mm X 15mm X INT 12.4mm, opal diffuser, end caps and mounting clips c/w Atlas 9.6/m 4000K IP20 LED Tape with CRI 90 and remote **NON DIMMING** control gear

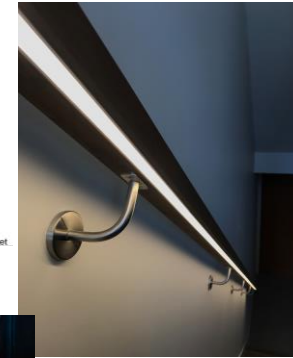

Available in round or square as well as symmetrical or asymmetrical design, the Pilot Handrail Light is the perfect solution to discretely integrate a highly-functional light into the built environment. This luminaire provides an unobtrusive light with minimal glare and a high degree of uniformity when spaced evenly along handrails.

With four different models and two unique shells, the Pilot Handrail Series can be customised to suit a range of different sizes of round and square handrails. The Pilot Round Handrail is perfect for round handrails, while the Pilot Flat Handrail is designed for square handrail applications.



Top Fixed SS Handrail Profiles

Finish
PS
SS

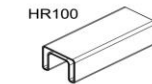
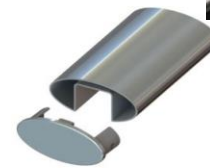
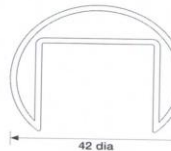
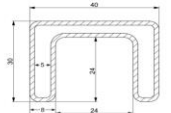
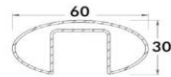

Round Flat